



# LED Par Light-Zoom

(TV-NW1240P)

### Main features:

- ⊙ CTO color temperature adjustment: 2800-9000K.
- ⊙ Set the powerful beam, dyeing function in one.
- ⊙ Uniform RGBW color mixing system and rainbow effect.
- ⊙ Linear focusing system, smooth, silent.
- ⊙ 0~100% smooth dimming.
- ⊙ Strobe: a variety of different frequencies of the strobe effect.
- ⊙ Compact structure, no noise.
- ⊙ No flashing under the HD camera.

### Structure:

- ⊙ Display screen: LCD display screen.
- ⊙ Signal input / output: three-core Canon head socket.
- ⊙ Socket: Power connector input / output.
- ⊙ Protection level: IP20.
- ⊙ Working environment: -10°C -45°C.

### Control:

- ⊙ Control mode: DMX, manual master, self-travel, voice control, RDM.
- ⊙ Control channel: 11 / 16.
- ⊙ It can be upgraded through the DMX data cable.
- ⊙ The DMX address code can be changed from the console, and the machine is reset.

### Optical system:

- ⊙ Light source: 12 \* 40W, RGBW LED lamp bead.
- ⊙ Expected service life of LED: 20000H.
- ⊙ Zoom range: 5° -45°, 9 x zoom range.
- ⊙ Efficient zoom optical system ensures clear and wide range of beam and dyeing effect.

### Physical parameters:

- ⊙ Input voltage: 110-240 V, 50 / 60 Hz.
- ⊙ Power: 440W.
- ⊙ Net weight: 6.3 Kgs.
- ⊙ Dimensions: 343 \* 290 \* 250mm.
- ⊙ Maximum online number: 6 (240V / 50Hz); 3 (100V / 60Hz) 1.5mm power cord.

### Factory configuration:

- ⊙ instructions.
- ⊙ power line.
- ⊙ insurance rope.
- ⊙ signal wire.

### Product size chart:

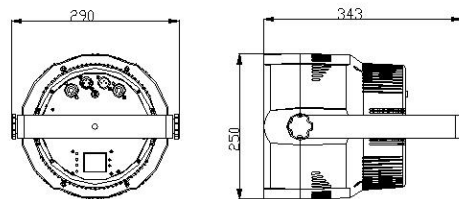

### Product illuminance table:

